

# TURNKEY FACILITY OFFERING

*Immediately Accepting Offers • Real Estate Included*

aptuit



**Complete API Contract Manufacturing Facility  
Including State of the Art Lab & Processing Suites.**

1701 W Vine St, Harrisonville, MO 64701



**HERITAGE**  
GLOBAL PARTNERS  
ASSET ADVISORY & AUCTION SERVICES

For more information including a photo gallery,  
equipment list, and more, please visit

[www.hgpauction.com](http://www.hgpauction.com)

Items subject to prior sale. Buyers are advised &  
encouraged to inspect equipment and read  
all Terms and Conditions prior to auction.

# TURNKEY FACILITY OFFERING: IMMEDIATELY ACCEPTING BIDS

COMPLETE API CONTRACT MANUFACTURING FACILITY INCLUDING STATE OF THE ART LAB & PROCESSING SUITES



## SITE HIGHLIGHTS

- 25,000 SQ FT ACQUIRED IN 2007
- ELEVEN TOTAL ACRES
- THREE ACRES CURRENTLY DEVELOPED
- SIZED TO SUPPORT PHASE I, II, AND III TRIALS AS WELL AS NICHE COMMERCIAL SCALE
- EXPERTISE IN HIGH-POTENCY COMPOUNDS
- FULL LAB



## ISOLATED SUITES EQUIPMENT

- 1 - 250-GALLON, GLASS-LINED REACTORS
- 2 - 100-GALLON, GLASS-LINED REACTORS
- 1 - 30-GALLON, GLASS-LINED REACTOR
- 1 - 100-LITER, GLASS-LINED REACTOR
- 1 - MULTI-KILO, SCALABLE BIOTAGE, CHROMATOGRAPHY SYSTEM
- 1 - 9-LITER LYOPHILIZER
- 1 - CRYOGENIC CAPABILITY

**ABOUT 10 KG/BATCH MAXIMUM**



aptuit

To submit an offer or schedule a preview, visit our website @ [www.hgpauction.com](http://www.hgpauction.com)



**LOCATION: 1701 W VINE ST, HARRISONVILLE, MO 64701**



## **API EQUIPMENT**

- 4 - 300 GALLON, GLASS-LINED REACTORS
- 1 - 200 GALLON HASTELLOY REACTOR
- 1 - 200 GALLON GLASS-LINED REACTOR
- 1 - 100 GALLON GLASS-LINED REACTOR
- 1 - 100 GALLON GLASS-LINE REACTOR (150 PSI/255 OC)
- 1 - PORTABLE 50 GALLON GLASS-LINED REACTOR
- 1 - PORTABLE 30 GALLON GLASS-LINED REACTOR

**100 KG/BATCH MAXIMUM, METRIC TONS ANNUALLY**

**CONTACT**

**Nick Dove**

**Tel: 858-847-0659 Email: [ndove@hginc.com](mailto:ndove@hginc.com)**

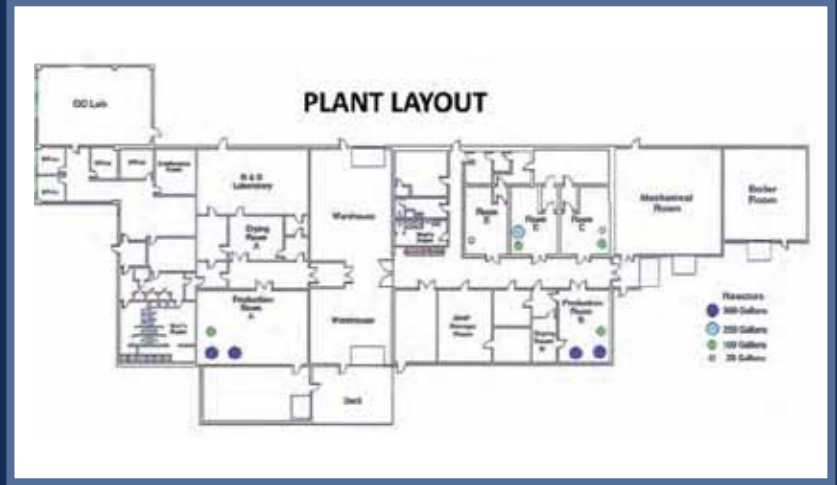

Scan this QR Code with your smartphone for More Information.

## Contact Information

**CONTACT NICK DOVE TO SUBMIT AN OFFER OR SCHEDULE A VISIT**

Nick Dove, Tel: 858-847-0659  
Email: ndove@hginc.com

For more information including a photo gallery, equipment list, and more, please visit us online at [www.hgpauction.com](http://www.hgpauction.com). Items subject to prior sale. Buyers are advised & encouraged to inspect equipment and read all Terms and Conditions prior to auction.



## Immediately Accepting Turnkey Offers • Real Estate Included

# Complete API Contract Manufacturing Facility. Including State of the Art Lab & Processing Suites. Harrisonville, MO.

**TURNKEY FACILITY OFFERING**  
Starting: Immediately Accepting Bids

**FACILITY LOCATION**  
1701 W Vine St, Harrisonville, MO 64701

**FACILITY PREVIEW**  
Preview By Appointment Only.  
Contact Nick Dove to submit an offer or schedule a Visit.

For more information including a photo gallery, equipment list, and more, please visit us online at [www.hgpauction.com](http://www.hgpauction.com). Items subject to prior sale. Buyers are advised & encouraged to inspect equipment and read all Terms and Conditions prior to auction.

**WOULD YOU LIKE TO SELL AN ASSET?**  
Simply call 1.650.207.0627 and speak with Kirk Dove, Managing Partner for more information. We will be glad to listen to your specific needs and from that HGP can prepare a detailed solution for your review that will maximize the returns for you're assets for the company and It's Shareholders.

**GLOBAL HEADQUARTERS**  
Hacienda Del Mar  
12625 High Bluff Drive  
San Diego, CA 92130  
Phone: (877) 303.8040  
Fax: (866) 388.8595

**FIRST CLASS MAIL**

**POSTMASTER:** Dated Material.  
Please Deliver Promptly.

Presorted First Class Mail  
U.S. Postage  
**PAID**  
San Diego, CA  
Permit No. 00

For complete Terms of Sale, visit our website at:

[www.hgpauction.com](http://www.hgpauction.com)

AFFILIATIONS



IDEMA



INDUSTRIAL AUCTIONEERS ASSOCIATION



semi

