

DRAWING NUMBER:  
**S6390**

REVISIONS

A

BY: S. CLARK  
DATE: 4/20/04  
APP: G. NITCH  
DATE: 4/20/04

UPDATED DRAWING PER KOLPAK'S SPECIFICATIONS.

B

BY: S. CLARK  
DATE: 5/5/04  
APP:  
DATE:

UPDATED DRAWING PER KOLPAK'S SPECIFICATIONS.

C

BY: G. NITCH  
DATE: 11-02-04  
APP:  
DATE:

UPDATED DRAWING PER CATALOG DOOR LOCATION.

D

BY: G. NITCH  
DATE: 2-07-08  
APP:  
DATE:

REVISED TITLEBLOCK

E

BY: G. NITCH  
DATE: 2-07-12  
APP:  
DATE:

ADDED BTUH RATING

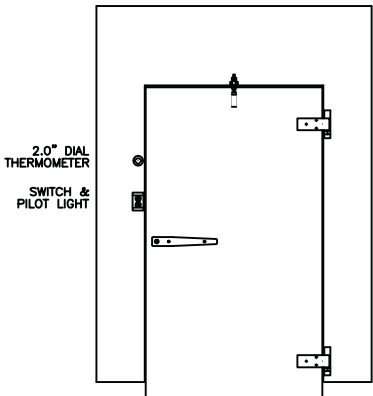
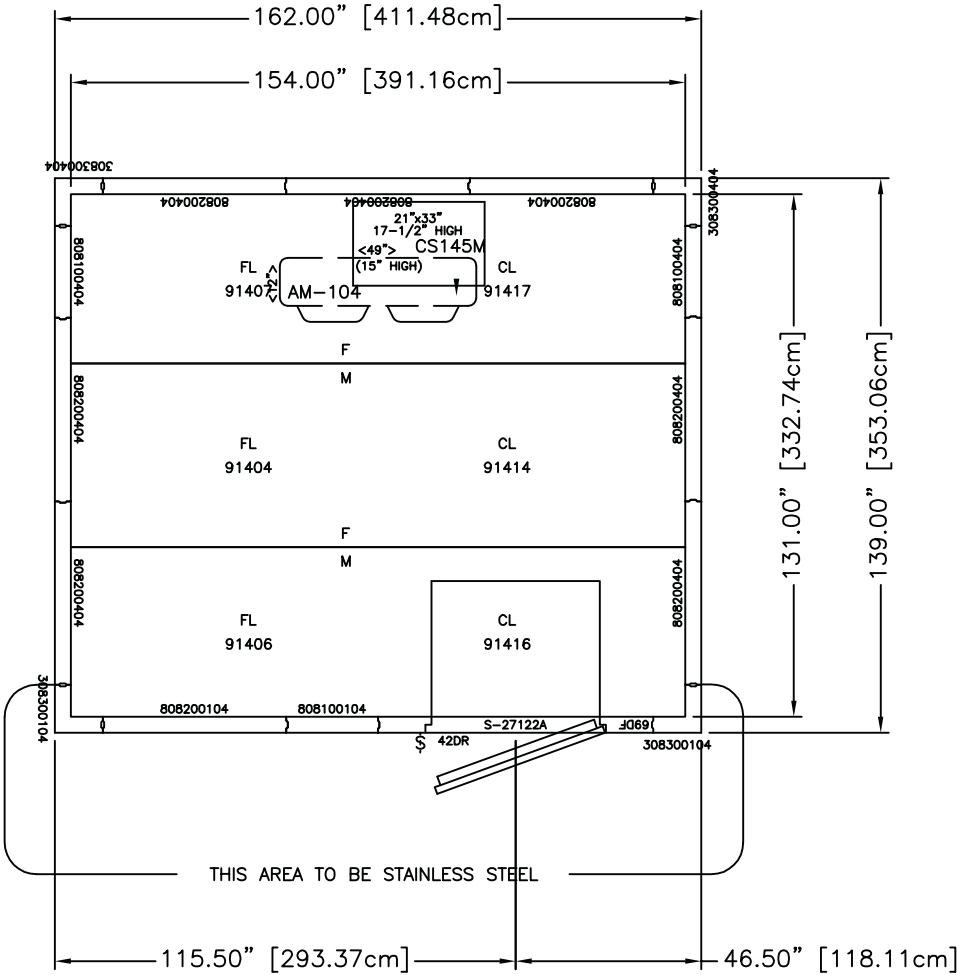

DOOR S-52338A01040104  
THRESHOLD DETAIL 27  
69x94.25DS 42x78 DR RH RMP CLR  
FRAME=22SS/GL PLUG=22SS/GL

"THIS WALK-IN TO BE INSTALLED WITH TILE & GROUT OR MASONARY WEAR SURFACE COVERING WALK-IN FLOOR. GALVANIZED FLOORING HAS TO BE COVERED TO MEET N.S.F. APPROVAL."

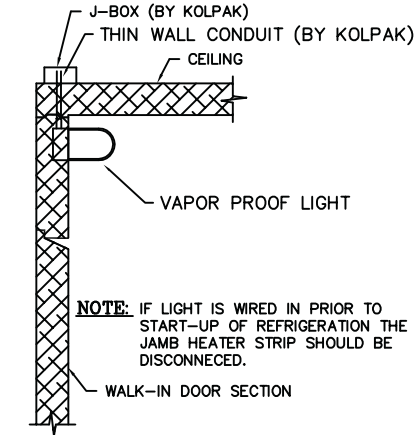
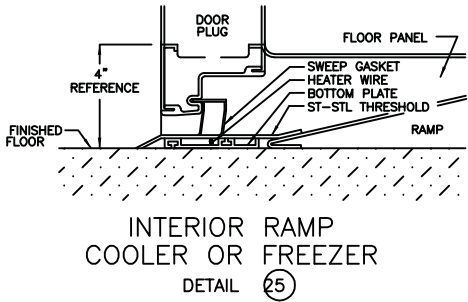

- THRU-CEILING ELECTRICAL -



**IMPORTANT NOTE!**  
GENERAL CONTRACTOR AND INSTALLER SHALL REFER TO KOLPAK DESIGN AND SPECIFICATION MANUAL WHICH IS AVAILABLE AT ALL AUTHORIZED KOLPAK DEALERS AND REPRESENTATIVES FOR FLOOR PREPARATION AND OTHER INSTALLATION REQUIREMENTS.

ALLOW MINIMUM 1" CLEARANCE  
ALL AROUND WALK-IN.

## WALK-IN SPECIFICATIONS

**SIZE:** 13'-6" X 11'-7" X 8'-6 1/4"

## INSULATION:

4" FOAMED IN PLACE URETHANE  
2.2 LB. DENSITY  
"K" FACTOR .121 - "U" FACTOR .030  
"R" VALUE = 33  
UNDERWRITERS LABORATORIES INC.  
54M4  
SURFACE BURNING CHARACTERISTICS  
R8160  
4" MAX CORE MATERIAL  
6" MAX CORE MATERIAL  
FLAME SPREAD: 25  
SMOKE DEVELOPED: 200  
DOOR SECTION FILE: E46140

## EXTERIOR FINISH:

AS SHOWN - 22 GA STAINLESS STEEL  
BALANCE - 26 GA STUCCO GALVALUME  
EXTERIOR TOP - 26 GA STUCCO GALVALUME

## INTERIOR FINISH:

WALLS: 26 GA STUCCO GALVALUME  
COOLER CEILING: 26 GA STUCCO GALVALUME

## FLOOR TYPE:

COOLER - 16 GA SMOOTH GALVANIZED

## HEIGHT:

OD 8'-6 1/4" ID 7'-10 5/8"  
ID MINUS TILE & GROUT THICKNESS

## DOORS:

DOOR S-52338A01040104  
69x94.25DS 42x78 DR RH RMP CLR  
FRAME=22SS/GL PLUG=22SS/GL  
115-60-1/1.5 AMPS

## ACCESSORIES:

- (1) INTERIOR ENTRANCE RAMP - 42" X 38"
- (1) THRU-CEILING ELEC. (THRU WALL)

## REFRIG: AIR COOLED / PRE-CHARGED LINES

HERMETIC  
PCL145M 1-1/2hp R-404A 208/230-60-1 12.2 AMPS  
12,170 BTUH @ 95° AMBIENT TEMPERATURE  
L=33",W=25 1/2",H=19 1/4",LBS.=258  
AM-104 EVAPORATOR 115-60-1 4.2 AMPS  
L=45.5",W=12",H=15",LBS.=49  
10' PRE-CHARGED LINES  
PUMP DOWN KIT

### NOTE!

IMPORTANT: VERIFY WALL HEIGHTS,  
ALL DIMENSIONS AND METAL FINISHES  
BEFORE APPROVING DRAWING.

### IMPORTANT

PLEASE NOTE  
WALK-IN CEILING NOT DESIGNED FOR  
FOOT TRAFFIC OR STORAGE

### IMPORTANT

PLEASE NOTE  
SPECIAL NOTE TO GENERAL CONTRACTOR AND HIS  
SUBCONTRACTOR FOR QUARRY TILE OR CONCRETE  
WEARING FLOORS: THE SHEET METAL PANEL FACINGS  
MAY BE SUSCEPTIBLE TO STAINING DUE TO  
EXCESSIVE MOISTURE CREATED BY HYDRATION OF  
CONCRETE TYPE MATERIALS: THEREFORE, IT IS  
ABSOLUTELY NECESSARY THAT EACH ROOM BE  
PROPERLY VENTILATED. ALSO NOTE THAT SPECIAL  
PRECAUTIONS MUST BE TAKEN WHEN USING MURIATIC  
ACID DUE TO EFFECTS HYDROCHLORIC ACID FUMES  
HAVE ON ALUMINUM AND STAINLESS STEEL.

THIS PRINT IS THE PROPERTY OF THERMO FISHER. THE INFORMATION CONTAINED HEREIN IS CONFIDENTIAL. ITS USE IS RESTRICTED TO THE USER'S BUSINESS ONLY. IT IS NOT TO BE REPRODUCED OR USED IN ANY PROCESS OF MANUFACTURING WITHOUT WRITTEN PERMISSION FROM THE COMPANY AND IS RETURNABLE UPON DEMAND. ANY INFRINGEMENT UPON THE PATENT RIGHTS SHOWN HEREIN, WHETHER BY INVOICE OR PART, WILL BE SEVERELY PROSECUTED.				<b>Thermo Fisher</b> Diagnostics <b>SCIENTIFIC</b> Anatomical Pathology 171 Industry Drive Phone: 1.800.547.7429 www.thermo.com Pittsburgh, PA 15275-1034 Fax: 1.412.788.1138			
TOLERANCES UNLESS OTHERWISE SPECIFIED				TITLE:			
LINEAR VARIATIONS:				MORTUARY REFRIGERATOR			
UP TO 24"				LWR-W-5, WALK-IN			
24" TO 48"				CUSTOMER:			
48" TO 72"				DRAWN BY:			
72" TO 120"				DATE:			
ANGULAR VARIATIONS:				SCALE:			
≤ 1"				1/2" = 1'-0"			
INTERNAL USE ONLY				REF. NUMBER:			
QUOTE NUMBER:				BOR			
S.O. NUMBER:				DATE:			
4-01-97				4-29-97			
AS PART OF OUR POLICY OF CONTINUING DEVELOPMENT, THERMO FISHER RESERVES THE RIGHT TO ALTER SPECIFICATIONS WITHOUT PRIOR NOTICE.				CHECKED BY:			
RMB				DATE:			
4-29-97				S6390			
APPROVED BY:				DATE:			
JZ				4-29-97			
SHEET 1 OF 1				REVISION			
E				E			